

CLEANING AND STORAGE

- To clean your product, first turn it OFF and UNPLUG the unit.
- Use a soft cloth to wipe the housing. DO NOT use water or any other chemical solution or cleaner. DO NOT soak or immerse the product in water or liquid.
- DO NOT ATTEMPT TO TAKE THE PRODUCT APART.
- Store in a dry place away from excessive heat and direct sunlight.
- Regular cleaning will ensure optimum performance and appearance of the product.
- DO NOT kink the power cord when storing or while in use.

REMOTE CONTROL BATTERY REPLACEMENT

- On the back of the remote, press the release button on the bottom right hand side. This will allow the tray containing the battery to be released. Release the tray by squeezing the small lip and pulling down the tab at the bottom of the remote (Fig. 2).

- This product contains a button cell battery. If swallowed, it could cause severe injury or death in just 2 hours. Seek medical attention immediately.

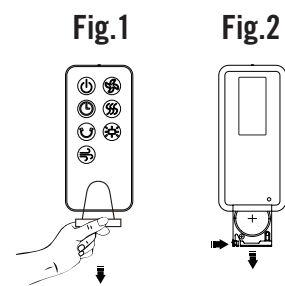

- Replace the battery with one new CR2025 button battery. Important: Install only new batteries of the same type in your product. Failure to insert batteries in the correct polarity, as indicated in the battery compartment, may shorten the life of the batteries or cause batteries to leak. Do not mix old and new batteries. Do not mix Alkaline, Standard (Carbon-Zinc) or Rechargeable (Nickel Cadmium) or (Nickel Metal Hydride) batteries. Danger of explosion if battery is incorrectly replaced. DO NOT DISPOSE OF BATTERY IN FIRE, BATTERY MAY EXPLODE OR LEAK

HAVE A PROBLEM? PLEASE CONTACT CUSTOMER SERVICE.

Should you have any questions or comments please contact us at: customerservice@blackstoneltd.com or by phone at 1-888-525-7969

WARRANTY: This product includes a one (1) year warranty, which covers manufacturer defects and workmanship under normal use. Warranty is offered only to the original purchaser. Proof of purchase is required. Proof of purchase constitutes a dated sales receipt. This warranty is void if the product(s) have been subject to abuse such as: being dropped which could result in damage to the product cabinets, motors, product controls, etc. immersion in or exposure to water, exposure to excessive heat, outdoor usage, any use other than household use, disassembly, repair or alteration by anyone other than an authorized service provider, use on improper voltage or current, or any use contrary to the user instructions. Batteries and battery life are not covered in this warranty. DO NOT attempt to repair any electrical or mechanical functions of this product; doing so will void this warranty and could lead to injury.

FCC STATEMENT OF COMPLIANCE

- This device complies with Part 15 of the FCC Rules. Operation is subject to the following two conditions: (1) this device may not cause harmful interference, and (2) this device must accept any interference received, including interference that may cause undesired operation.

Instruction manual shall include,

- Warning: Changes or modifications to this unit not expressly approved by the party responsible for compliance could void the user's authority to operate the equipment.

-NOTE: This equipment has been tested and found to comply with the limits for a Class B digital device, pursuant to Part 15 of the FCC Rules.

These limits are designed to provide reasonable protection against harmful interference in a residential installation. This equipment generates, uses and can radiate radio frequency

energy and, if not installed and used in accordance with the instructions, may cause harmful interference to radio communications. However, there is no guarantee that interference will not occur in a particular installation. If this equipment does cause harmful interference to radio or television reception, which can be determined by turning the equipment off and on, the user is encouraged to try to correct the interference by one or more of the following measures:

- Reorient or relocate the receiving antenna.
- Increase the separation between the equipment and receiver.
- Connect the equipment into an outlet on a circuit different from that to which the receiver is connected.
- Consult the dealer or an experienced radio/TV technician for help.

REMOTE BATTERY STATEMENT

- Use type CR2025 batteries only.
- Install only new batteries of the same type in your product.
- Failure to insert batteries in the correct polarity, as indicated in the battery compartment, may shorten the life of the batteries or cause batteries to leak.
- Do not mix old and new batteries.
- Do not mix Alkaline, Standard (Carbon-Zinc) or Rechargeable (Nickel Cadmium) or (Nickel Metal Hydride) batteries.
- Danger of explosion if battery is incorrectly replaced.
- Batteries should be recycled or disposed of as per state or local guidelines.



BLACKSTONE.
CASCADE
CAPRI

ALL SEASON HEATER AND FAN COMBO INSTRUCTION MANUAL

MODEL: CASC-24-P, CASC-24-C

FAN
Input Rating: AC 120 V
60 Hz / 1500 W

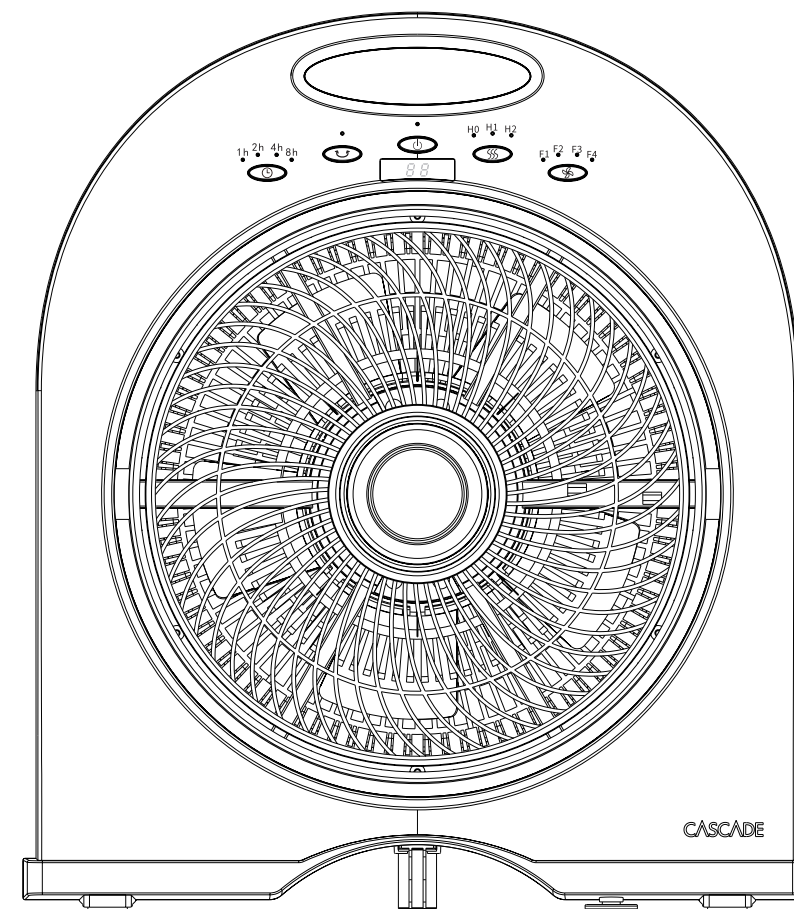

IMPORTANT, RETAIN THESE INSTRUCTIONS FOR FUTURE REFERENCE:

READ CAREFULLY | FOR HOUSEHOLD USE ONLY

SAVE THESE INSTRUCTIONS

This product contains a button battery. If swallowed, it could cause severe injury or death in just 2 hours. Seek medical attention immediately.

Blackstone International Ltd. and other trademarks are the property of the respective owners. All other brand names and logos are registered trademarks of their respective owners.

MADE IN CHINA | Distributed by: Blackstone International, Ltd.

PLEASE READ AND SAVE THESE INSTRUCTIONS WHEN USING ELECTRICAL APPLIANCES, BASIC PRECAUTIONS SHOULD ALWAYS BE FOLLOWED TO REDUCE THE RISK OF FIRE, ELECTRIC SHOCK AND INJURY TO PERSON OR PROPERTY, INCLUDING THE FOLLOWING:

- Read all instructions before using this product.
 - Use this product only as described in this manual. Any other use not recommended by the manufacturer may cause fire, electrical shock or injury to person or property and may void the warranty.
 - Always unplug unit before assembly, disassembly or cleaning.
 - Always unplug unit when not in use, when moving from one location to another and before cleaning.
 - To disconnect, grasp the plug and pull it from the wall outlet. DO NOT unplug by pulling on cord.
 - The use of attachments is not recommended nor sold by the manufacturer and may cause hazards.
 - Avoid contact with moving parts.
 - DO NOT operate any product with a damaged cord or plug, after a malfunction, or if dropped or damaged in any manner.
 - DO NOT operate the product in the presence of explosive and/or flammable fumes.
 - DO NOT place the product or any parts near an open flame, cooking or other heating appliances.
 - Extreme caution is necessary when product is used by or near children and whenever the product is left operating and unattended.
 - This product is intended for household use only and not for commercial or industrial use.
 - DO NOT use outdoors.
 - Always use on a dry, level surface.
- DO NOT operate if the product housing is removed or damaged.
 - A loose fit between the AC outlet and plug may cause over-heating of the plug; consult a qualified electrician.
1. DO NOT run cord under carpeting. DO NOT cover cord with throw rugs, runners, or the like. Arrange cord away from traffic areas and where it will not be tripped over.
- DO NOT connect the product to any power sources other than a 120V alternating current polarized outlet.
 - WARNING: To reduce the risk of electric shock, DO NOT use this product with any solid-state speed control and DO NOT insert finger or any object into grill.
 - WARNING: KEEP BATTERIES OUT OF REACH OF CHILDREN
 - Swallowing may lead to serious injury in as little as 2 hours or death, due to chemical burns and potential perforation of the esophagus.
 - If you suspect your child has swallowed or inserted in their body a button battery, immediately seek urgent medical assistance.
 - Examine devices and make sure the battery compartment is correctly secured, e.g. that the screw or other mechanical fastener is tightened. Do not use if compartment is not secure.
 - Dispose of used button batteries immediately and safely. Flat batteries can still be dangerous.
 - Tell others about the risk associated with button batteries and how to keep children safe.

Note: To reduce the risk of fire, electrical shock and injury to a person or property, do not plug this product into extension cords. The extension cord could overheat. Do not plug the product into any cord connected devices. This includes surge protectors, multiple outlet adapters, and power strips.



WARNING: Chemical Burn Hazard. Keep batteries away from children. This product contains a lithium button/coin cell battery. If a new or used lithium button/coin cell battery is swallowed or enters the body, it can cause severe internal burns and can lead to death in as little as 2 hours.

Always completely secure the battery compartment. If the battery compartment does not close securely, stop using the product, remove the batteries, and keep it away from children. If you think batteries might have been swallowed or placed inside any part of the body, seek immediate medical attention.

The cells shall be disposed of properly, including keeping them away from children. Even used cells may cause injury.

TILT FUNCTION

The grille of the product can be tilted forward and backward 17 degrees. To tilt the product grille downwards, grasp the carry handle of the product with one hand and use your other hand to gently push the bottom of the product grille towards the back of the product until the desired angle is achieved. To tilt the product grille upwards, grasp the carry handle of the product with one hand and use your other hand to gently push the top of the product grille towards the back of the product until the desired angle is achieved.

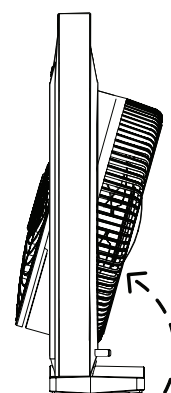

The product can be tilted **down** as much as 20° by pressing on the grill

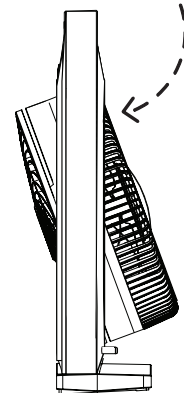

The product can be tilted **up** as much as 20° by pressing on the grill

REMOTE CONTROL

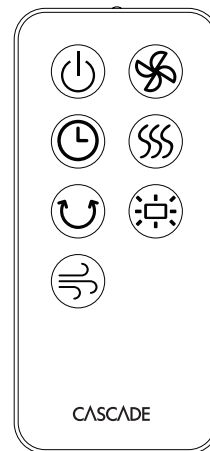

Heating To turn on the heater mode. After turning the product on, push this button will turn the heater on. Push one time, the heater goes to **H2** setting (1500W), push again, the heater goes to **H1** setting (750W), push it the 3rd time, the heater goes to **H0** (the heating element will be powered off but the fan blade will be still on), push the 4th time, the heater goes to **H2** setting again.

H1: 750W

H2: 1500W heater

H0: 0W heater

When pushing this button, LED sign shows the setting. After 10 seconds the LED signs goes back to the ambient temperature if no operation.

Switch Turn on/off the product (Default mode is fan at **F1** setting)

After plugging in, push this button to turn on the product. And the fan will also be on at **F1** setting and LED sign shows the ambient temperature, 3 seconds later, LED sign shows **F1**; 10 seconds later, LED sign shows the ambient temperature if no other operation. Push the button again will turn off the product.

Fan To turn on the fan mode.

After turning the product on, push this button will turn the fan on and the heating element will be powered off at once. Push one time, the fan goes to **F1** setting, push again, goes to **F2** setting, push the 3rd time, the fan goes to **F3** setting, push the 4th time, the fan goes to **F4** setting, push the 5th time, the fan goes back to **F1** setting. When pushing this button, LED sign shows the setting. After 10 seconds the LED signs goes back to the ambient temperature if no operation.

Oscillation After turning the product on, push this button will make the front grille oscillate.

Timing After turning the product on, you can push this button to set a timer. When the heater or fan works, push this button to set the timing from 3 hour to 15 hours. When pushing this button, LED sign shows the setting. After 10 seconds the LED signs goes back to the ambient temperature if no operation. When timing reaches, all function of the product will be turned off at once.

LED Sign & Indicator On/Off After turning the product on, you can push this button to turn the LED sign and all indicators off.

Mode (Only on remote) It is only effective when the fan button is on. When push this button, the fan mode changes from Standard to Evening, to Breeze, then go back to Standard.

EXPLANATION OF MODES

Standard Wind

The Standard Wind mode is simply the ECON, LOW, MED, HIGH speed settings and the LED segment will show "1" for 30 seconds when push the mode button, and then show the ambient temperature.

Evening Wind

The air flows as an evening breeze to a light night breeze, the LED segment will show "2" for 30 seconds when push the mode button, and then show the ambient temperature, and are detailed as follows:

ECON Evening Wind The air flow remains at ECON

LOW Evening Wind The air flow begins at LOW, after half an hour it will drop down to ECON

MED Evening Wind The air flow begins at MED, after half an hour it will drop down to LOW, after an additional half an hour it will drop down to ECON

HIGH Evening Wind The air flow begins at HIGH, after half an hour it will drop down to MED, after an additional half an hour it will drop down to LOW, after an additional half an hour it will drop down to ECON

Breeze Wind

Automatically selects wind speed randomly as you would find outdoors. And the LED segment will show "3" for 30 seconds when push the mode button. The speeds are detailed as follows:

ECON Breeze Wind The wind settings will fluctuate between MED, LOW and ECON in a 75 second wind cycle that repeats with ECON being the most common

LOW Breeze Wind The wind settings will fluctuate between MED, LOW and ECON in a 75 second wind cycle that repeats with LOW being the most common

MED Breeze Wind The wind settings will fluctuate between HIGH, MED, LOW and ECON in an 80 second wind cycle that repeats with MED being the most common

HIGH Breeze Wind The wind settings will fluctuate between HIGH, MED, LOW and ECON in an 80 second wind cycle that repeats with HIGH being the most common

IMPORTANT INSTRUCTIONS

1. Read all instructions before using this heater
2. This heater is hot when in use. To avoid burns, do not let bare skin touch hot surfaces. If provided, use handles when moving this heater. Keep combustible materials, such as furniture, pillows, bedding, papers, clothes, and curtains at least 3 feet (0.9m) from the front of the heater and keep them away from the sides and rear.
3. Extreme caution is necessary when any heater is used by or near children or invalids and whenever the heater is left operating and unattended.
4. Always unplug heater when not in use
5. Do not operate any heater with a damaged cord or plug or after the heater malfunctions, has been dropped or damaged in any manner. Discard heater, or return to authorized service facility for examination and/or repair.
6. Do not use outdoors
7. This heater is not intended for use in bathrooms, laundry areas and similar indoor locations. Never locate heater where it may fall into a bathtub or other water container.
8. Do not run cord under carpeting. Do not cover cord with throw rugs, runners, or similar coverings. Do not route cord under furniture or appliances. Arrange cord away from traffic area and where it will not be tripped over.
9. To disconnect heater, turn controls to off. then remove plug from outlet.
10. Connect to properly grounded outlets only.
11. Do not insert or allow foreign objects to enter any ventilation or exhaust opening as this may cause an electric shock or fire, or damage the heater.
12. To prevent a possible fire, do not block air intakes or exhaust in any manner. Do not use on soft surfaces like a bed, where openings may become blocked.
13. A heater has hot and arcing or sparking parts inside. Do not use it in areas where gasoline, paint, or flammable liquids are used or stored.
14. Use this heater only as described in this manual, Any other use not recommended by the manufacturer may cause fire, electric shock, or injury to persons.
15. Always plug heaters directly into a wall outlet/receptacle. Never use with an extension cord or relocatable power tap (outlet/power strip).
16. This heater may include an audible and a visual alarm to warn that parts of the heater are getting excessively hot. If the alarm sounds flashes, immediately turn the heater off and inspect for any objects on or adjacent to the heater that may cause high temperatures. DO NOT OPERATE THE HEATER WITH THE ALARM SOUNDING (FLASHING).
17. Hyperthermia can result in death. Symptoms of hyperthermia include high body temperature, headache, nausea, vomiting, tiredness, dizziness, fainting, and rapid pulse. If you begin to experience symptoms related to hyperthermia, turn off the heater and seek medical attention. To avoid excessive room temperatures which can cause hyperthermia: DO NOT leave product running unattended in a confined space around infants, or individuals with reduced physical, sensory, or mental capabilities.
18. This heater is for use on 120 volts.
19. To avoid excessive room temperatures which can cause hyperthermia: DO NOT leave product running unattended in a confined space around infants, or individuals with reduced physical, sensory, or mental capabilities.

ADDITIONAL NOTES

1. The product will beep each time when pushing the button on product or remote.
2. When plugging in, all indicators and LED sign are on for 1 second and then off. The product will beep one time.
3. When turning heater on, the fan is operated first: 10 seconds later, the heating element is turned on; when turning the heater off, the heating element is turned off at once, while the fan is not turned off until 10 seconds later. This is for more heating dissipation.
4. When pushing the fan button on product or remote, the heating element will be turned off at once and the indicator of heater button will be off; when pushing the heater button on product or remote, the heater mode will be operated and the indicator of fan button will be off.
5. This product includes both over-heating and tip-over protection.